



FOR TAX PURPOSES ONLY
 Prepared By:
Kathie Hoffman
 Ohio County Assessor

Legend			
Property Line	—	Original Lot Line	—
Edge of pavement or roadway	- - - -	Deed lot number (in parenthesis)	(15)
Corporation line	- · - · -	Parcel or index number	MAP-15
District line	- · - · -	Improvement	○
County Line	- · - · -	Railroad	—+—+—

Restriction

All tax maps created under the provisions of reappraisal legislation are the property of the Assessor of Ohio County, West Virginia and the reproduction, copying, modification, distributor sale of such tax maps or any copies thereof without the written permission of the Ohio County Assessor is prohibited by law.

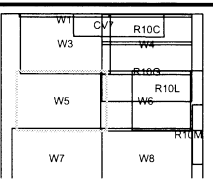

OHIO COUNTY - WEST VIRGINIA
 Office of Assessor

Map No: W5
Drawn By: David Weaver
Date: Jun 04, 2009
Scale: 1 inch = 100 feet