

VAUCLUSE
 Insert A
 See Sheets 3 and 4
 Scale 1" = 100'

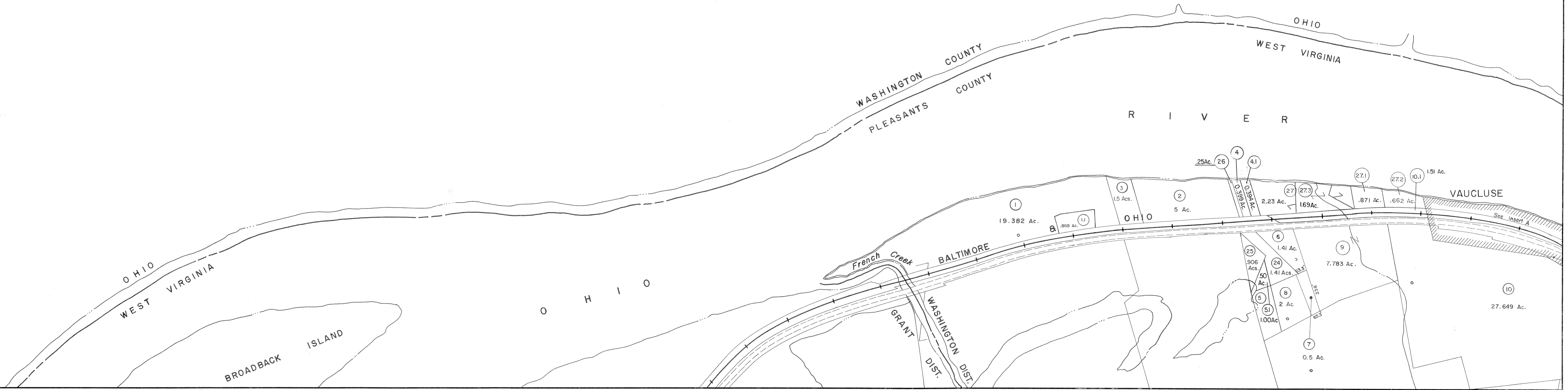

For Tax Purposes Only

Prepared by
PHOTRONIX, INCORPORATED
 790 King Avenue Columbus, Ohio

Legend

Property line	---
Edge of pavement or roadway	====
Corporation line	----
District line	----
County line	----
Original lot line	----
Deed lot number in parenthesis	()
Parcel or index number in circle	○
Improvement	○

-	-	1
-	3	4
-	6	7

Revisions

1	Revised to 7-80	ES1	3/22/01	REK	17
2	7-1-83	HBS	2/24/04		18
3	July 1985		4/9/05	S BH	19
4	7-1-86	S.P.H.			20
5	Rev. to 3-1-89	R.E.B.			21
6	OGIS 4-11-93	BVR			22
7	OGIS 12/11/93	DSH			23
8	O.G.I.S 12-1-96	J.E.B.			24

WASHINGTON
 PLEASANTS COUNTY, WEST VIRGINIA

Office of Assessor

WASHINGTON

City — Town — District:
 District: **3**
 Map No.: **3**
 Date, Aerial Photography: 4-7-59 Date, Map: 8-15-60
 Photo No.: 24, 25 Map Scale: 1" = 400'