

1/34

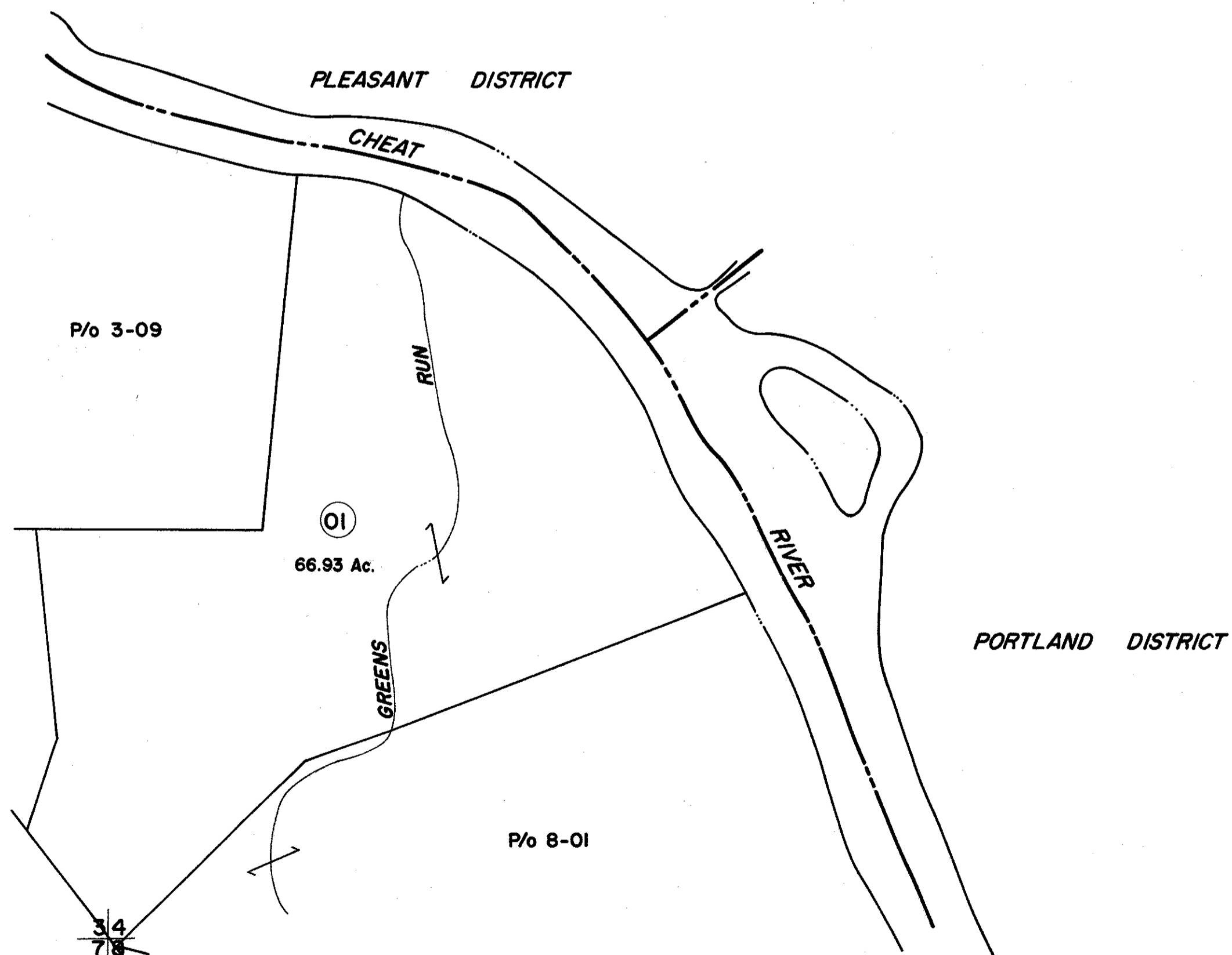

4/8

FOR TAX PURPOSES ONLY

Prepared by
L. ROBERT KIMBALL
 Consulting Engineer
 Ebensburg, Pennsylvania

Legend

Property line	-----	Original lot line	-----
Edge of pavement or roadway	-----	Deed lot number in parenthesis	(15)
Corporation line	-----	Parcel or index number in circle	⓪
District line	-----	Improvement	○
County line	-----	Railroad	-----

Revisions

1	Revised to 7-1-81	CBF	9
2	Revised to 7-1-83	RLB	10
3	7/1/84	RLB	11
4	REV. TO 7-1-86	NCS	12
5	OGIS	10-28-91	NK
6			13
7			14
8			15
			16
			17
			18
			19
			20
			21
			22
			23
			24

STATE OF WEST VIRGINIA
 COUNTY OF PRESTON
 Office of Assessor

KINGWOOD DISTRICT
 SHEET 04

Date, Aerial Photography: APRIL, 1960
 Photo No: 245
 Date, Map: NOV, 1962
 Scale: 1" = 400'