

41|42
48|49

42|43
49

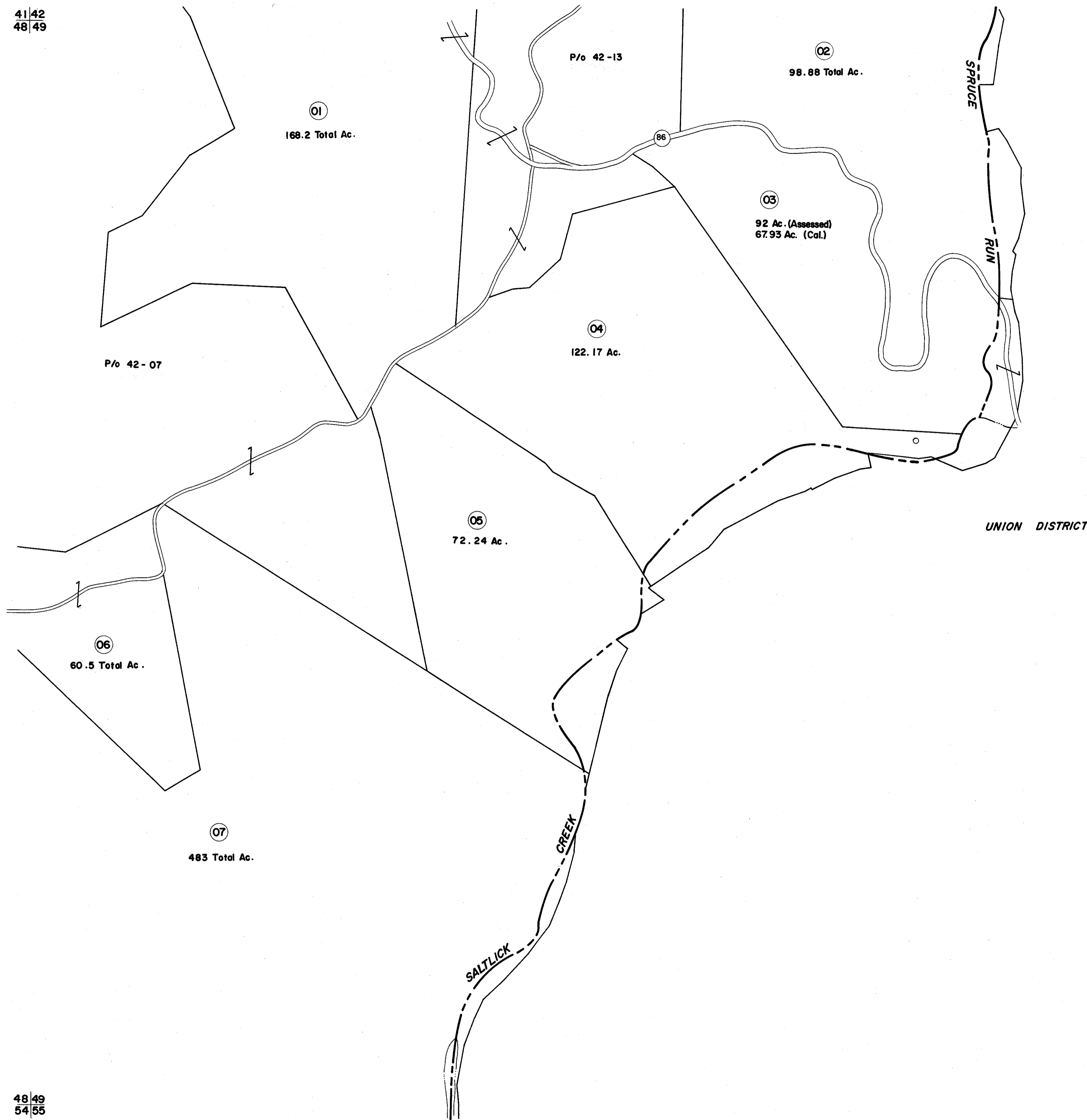

48|49
54|55

49
55

FOR TAX PURPOSES ONLY

Prepared by
L. ROBERT KIMBALL
Consulting Engineer
Ebensburg, Pennsylvania

Legend

Property line	Original lot line	Deed lot number in parenthesis (15)
Edge of pavement or roadway	Parcel or index number in circle (16)	Improvement
Corporation line	District line	Railroad
District line	County line	

Revisions

1	Original to 7-1-85	9		17
2	REV. TO 7-1-85	NCS		18
3				19
4				20
5				21
6				22
7				23
8				24

STATE OF WEST VIRGINIA
COUNTY OF PRESTON
Office of Assessor

PORTLAND DISTRICT
SHEET 49

Date, Aerial Photography: APRIL, 1960 Date, Map: JULY, 1963
Photo No: 273 Scale: 1" = 400'