

12
89

23
910

GRANT DISTRICT

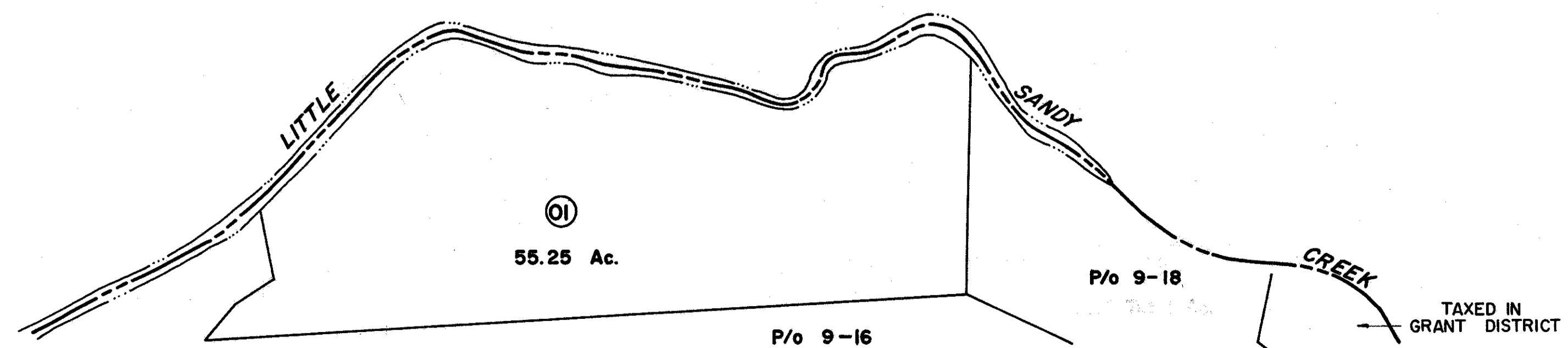

FOR TAX PURPOSES ONLY

Prepared by
L. ROBERT KIMBALL
Consulting Engineer
Ebensburg, Pennsylvania

Legend

Property line	Original lot line	(15)
Edge of pavement or roadway	Deed lot number in parenthesis	(P)
Corporation line	Parcel or index number in circle	(O)
District line	Improvement	
County line	Railroad	

Revisions

1	Revised to 7-81	DF	9	17
2	Revised to 7-83	SM	10	18
3	July, 1965	TK	11	19
4			12	20
5			13	21
6			14	22
7			15	23
8			16	24

STATE OF WEST VIRGINIA
COUNTY OF PRESTON
Office of Assessor

PLEASANT DISTRICT
SHEET 02

Date, Aerial Photography: APRIL, 1960 Date, Map: APRIL, 1963
Photo No: 291 Scale: 1"=400'