



**FOR TAX PURPOSES ONLY
PREPARED BY**
**SHERRY L. HAYES
PUTNAM COUNTY ASSESSOR**
MAPPING / GIS DEPARTMENT

ALL TAX MAPS CREATED UNDER THE PROVISIONS OF REAPPRAISAL LEGISLATION ARE THE PROPERTY OF PUTNAM COUNTY WEST VIRGINIA AND THE REPRODUCTION, COPYING, DISTRIBUTION OR SALE OF SUCH TAX MAPS OR ANY COPIES THEREOF WITHOUT THE WRITTEN PERMISSION OF THE PUTNAM COUNTY ASSESSOR IS PROHIBITED BY LAW.

Legend		
	Road ROW	
	Parcel Boundary	
	Rail ROW	
	Road-Rail ROW	
	District	
	Lot Lines	
	Road Easement	
	Parcel-Easement	
	Parcel-Road ROW	
	Parcel Hook	
	Utility_Easement	
	23 Parcel Number	
	001 Routing Number	
	(12) Deed Lot Number	

Revisions	

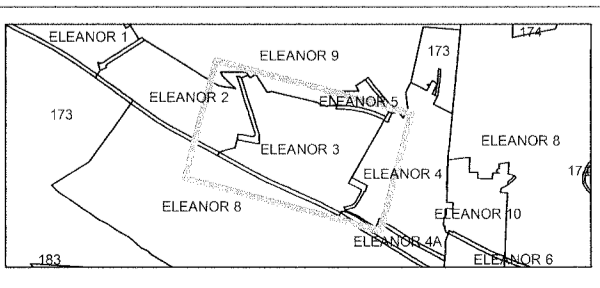

PUTNAM COUNTY
STATE OF WEST VIRGINIA
OFFICE OF ASSESSOR

District **ELEANOR TOWN**
Sheet No.: **ELEANOR 3**
Date, Aerial Photography: **2010**
Scale: **1" = 100'**