

100

100|01

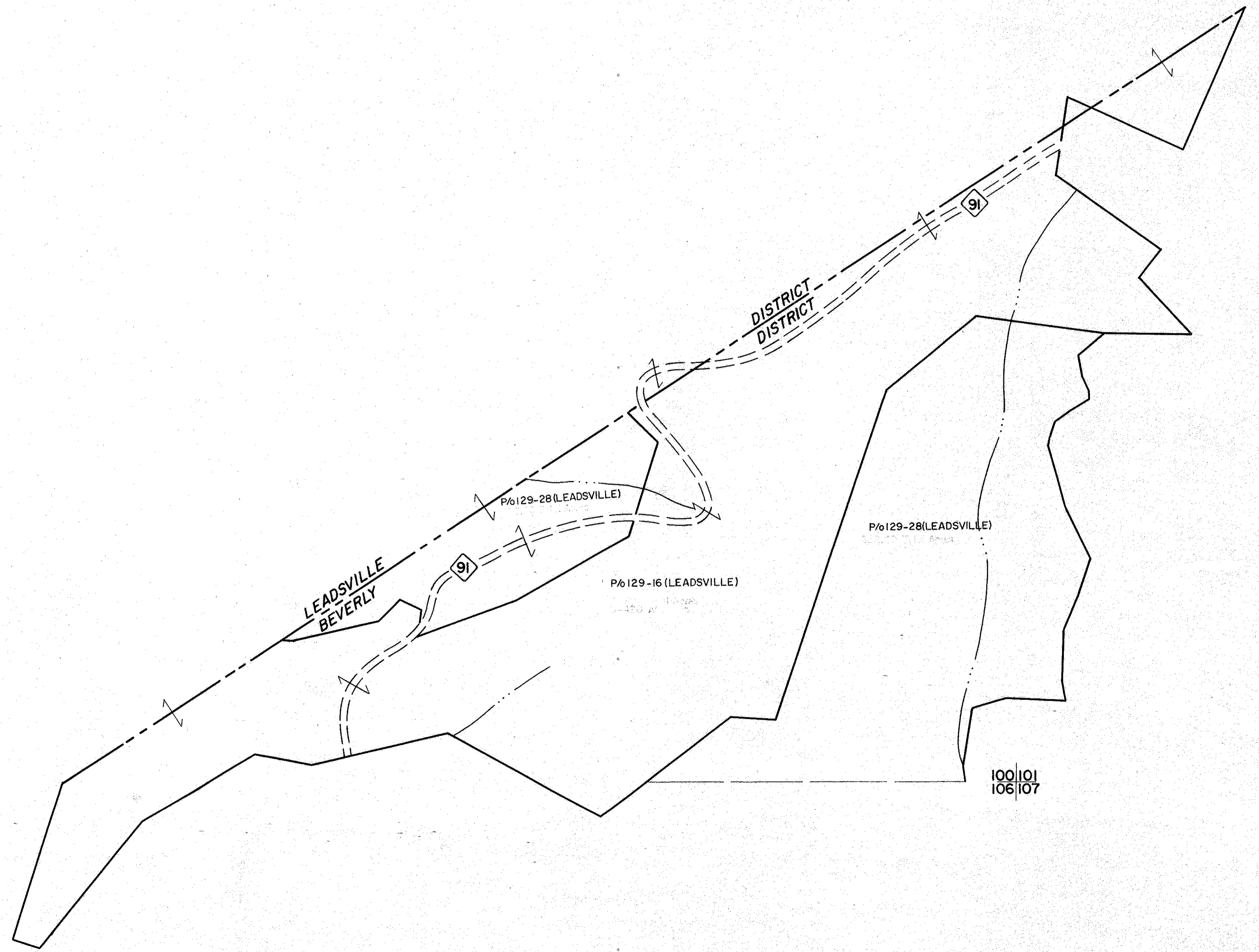
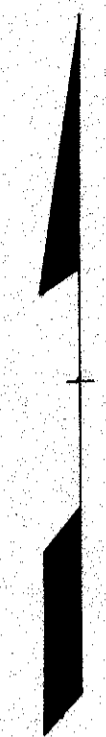

100  
106

100|01  
106|07

For Tax Purposes Only

Prepared by  
**MICHAEL BAKER, JR., INC.**  
Consulting Engineers  
Rochester, Pennsylvania

**Legend**

Property line	—	Original lot line	---
Edge of pavement or roadway	—	Dead lot number	(15)
Corporation line	---	Parcel or index number	(99)
District line	---	Improvement	o
County line	---	Railroad	+

**Revisions**

1	6-30-64	9	17
2	11-30-64	10	18
3	Revised to 7-1-69	11	19
4	0015 4-30-92 TL	12	20
5		13	21
6		14	22
7		15	23
8		16	24

**KEY MAP**

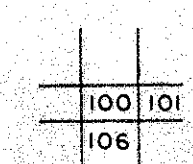

**RANDOLPH COUNTY**

STATE OF WEST VIRGINIA

Office of Assessor

DISTRICT

**BEVERLY**

**SHEET NO: 100**

Date, Aerial Photography: April, 1963 Date, Map: June, 1963  
Photo No: 385-6-13&15 Scale: 1"=400'