

- 116/6 0.26 AC
- 116/7 (361'x80'+338'x148.5')
- 116/8 (72'x206'+80'x200')
- 116/9 (56'x87')
- 116/12 (15'x88'x8'x85')
- 116/13 (9'x87'x16'x85')
- 116/14 (146'x188'x87'x11'x84')
- 116/15 (180'x84'x171'x88')
- 116/21 (20'x235'+/-)
- 116/22 (50'x/- x 100'+/-)

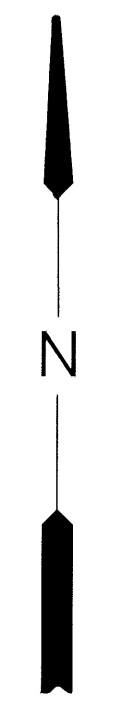

For Tax Purposes Only  
 Prepared by  
 McKenzie Engineering Corporation  
 806 Broad Street  
 Summersville, WV 26651

LEGEND	
Property line	Original lot line
Edge of pavement or roadway	Deed lot number (15)
Corporation line	Parcel or index number (99)
District line	Improvement
County line	Railroad

REVISIONS	
1	7/25/02 PKY
2	
3	
4	
5	
6	
7	
8	

**RESTRICTION**

All tax maps created under the provisions of reappraisal legislation are the property of Randolph County West Virginia and the reproduction, copying, distribution or sale of such tax maps or any copies thereof without the written permission of the Randolph County Assessor is prohibited by law.

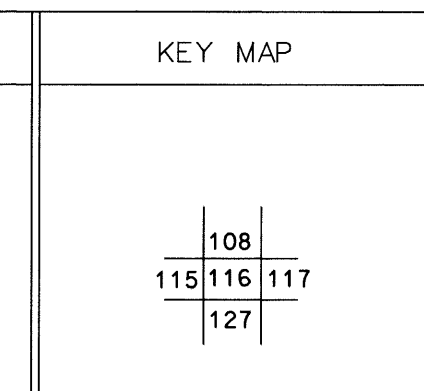

**RANDOLPH COUNTY**  
 STATE OF WEST VIRGINIA  
 Office of Assessor

**DISTRICT**  
 DRY FORK  
 SHEET NO: 116

Date, Aerial Photography: April, 1963  
 Photo No: 385-5-24  
 385-6-25

Date, Map: June, 1963  
 Scale: 1" = 400'