

146 | 147  
153 | 154

147  
154

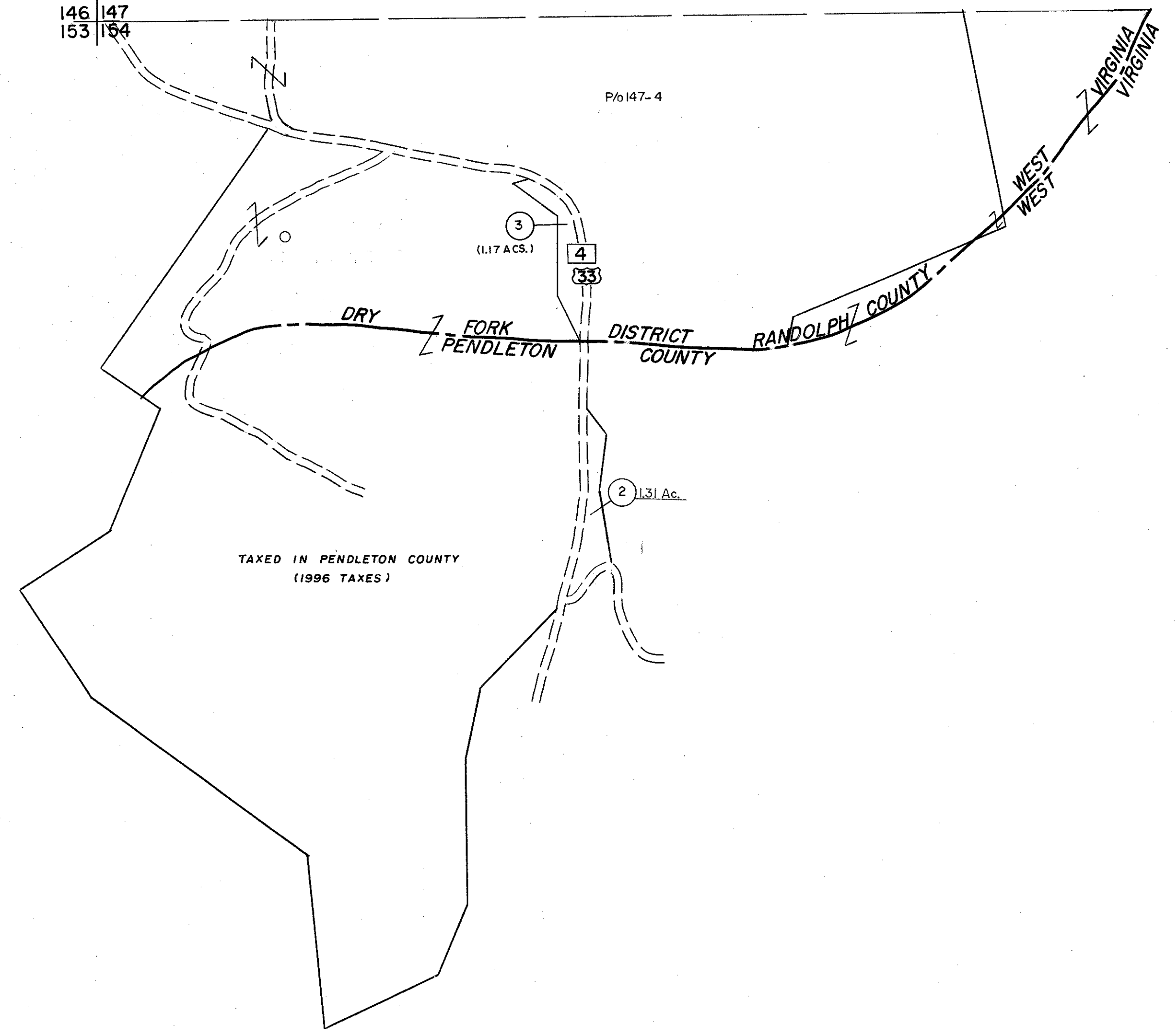

P/o 147-6

153 | 154

154

For Tax Purposes Only

Prepared by  
**MICHAEL BAKER, JR., INC.**  
Consulting Engineers  
Rochester, Pennsylvania

Legend

Property line	-----	Original lot line	-----
Edge of pavement or roadway	-----	Deed lot number	(15)
Corporation line	-----	Parcel or index number	(33)
District line	-----	Improvement	o
County line	-----	Railroad	+

Revisions

1	6-30-64	9		17	
2	REVISED TO 7-1-83	10		18	
3	REVISED TO 7-1-84	11		19	
4	OGIS 2-27-91 SAJ	12		20	
5	O.G.J.S 5-1-96 J.E.B	13		21	
6	SLS INC.-J.W.M. 3/97	14		22	
7		15		23	
8		16		24	

KEY MAP

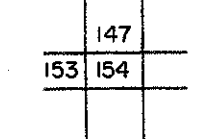

**RANDOLPH COUNTY**  
STATE OF WEST VIRGINIA  
Office of Assessor

DISTRICT

**DRY FORK**

**SHEET NO: 154**

Date, Aerial Photography: April, 1963 Date, Map: June, 1963  
Photo No: 385-7-29 Scale: 1"=400'