

212 213  
217 218

213 214  
218 219

217 218  
221

218 219  
221

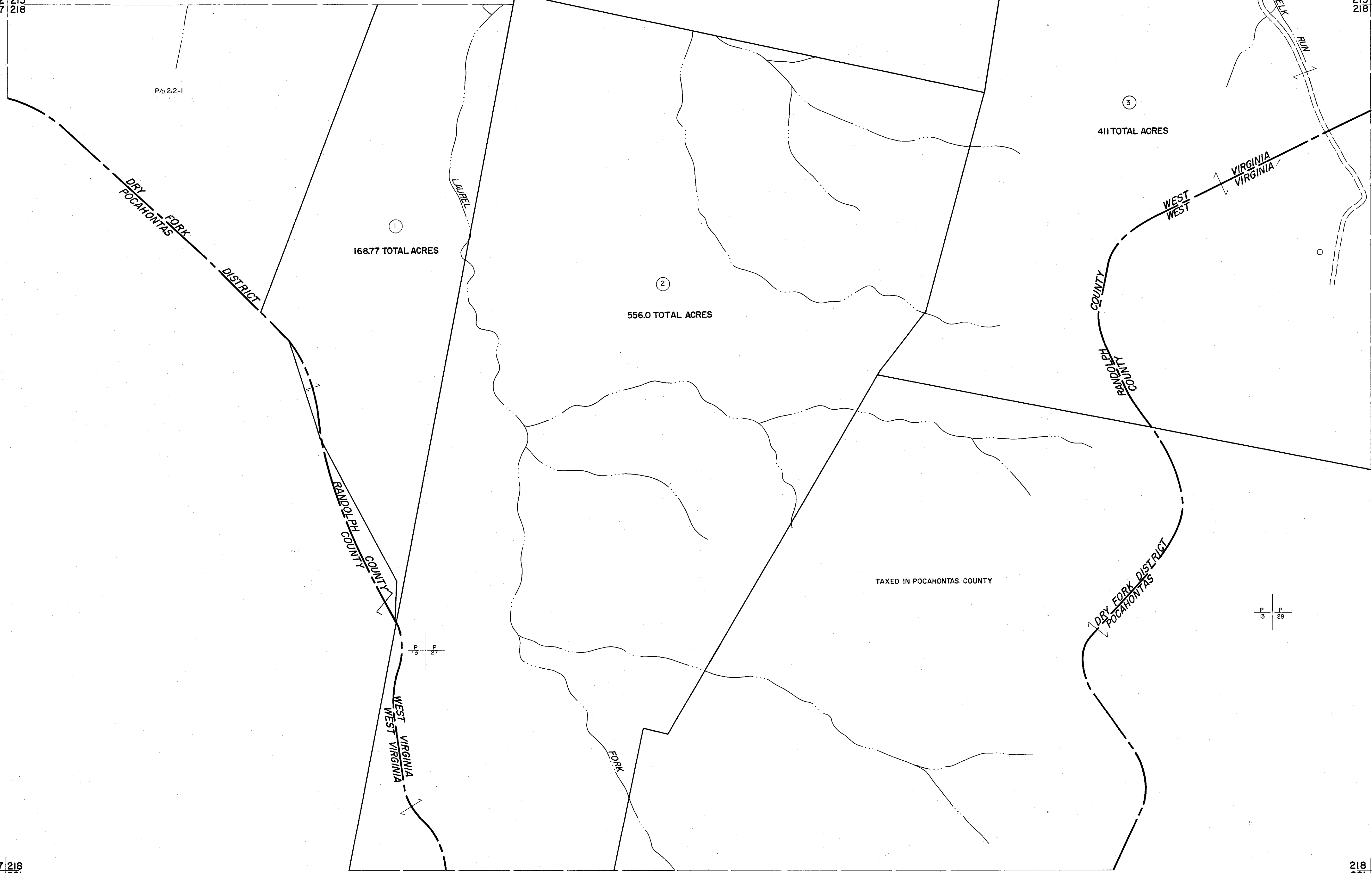

For Tax Purposes Only  
 Prepared by  
**MICHAEL BAKER, JR., INC.**  
 Consulting Engineers  
 Rochester, Pennsylvania

Legend	
Property line	—
Edge of pavement or roadway	—
Corporation line	—
District line	—
County line	—
Original lot line	—
Deed lot number	(15)
Parcel or index number	(2)
Improvement	—
Railroad	—

Revisions			
1	6-30-64	9	17
2	OGIS 3-4-91 SAJ	10	18
3		11	19
4		12	20
5		13	21
6		14	22
7		15	23
8		16	24

KEY MAP

**RANDOLPH COUNTY**  
 STATE OF WEST VIRGINIA  
 Office of Assessor

DISTRICT  
**DRY FORK**  
 SHEET NO:218  
 Date, Aerial Photography: April, 1963 Date, Map: June, 1963  
 Photo No: 385-13-28 Scale: 1" = 400'