

157 158  
162 163

158 160  
163 164

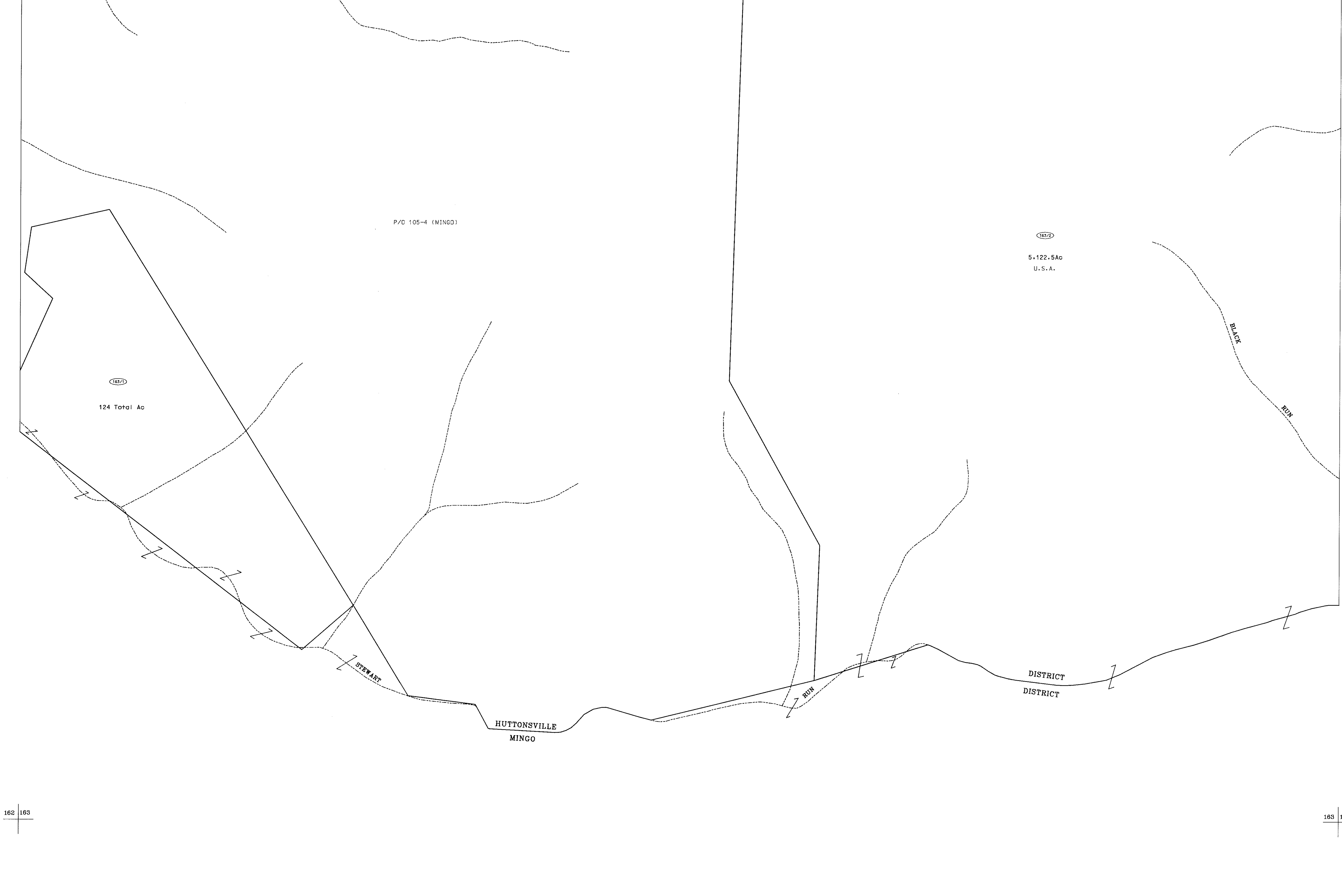
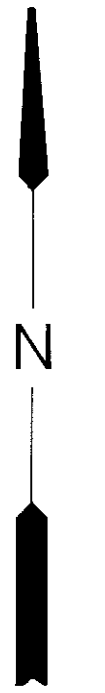

162 163

163 164

For Tax Purposes Only  
Prepared by  
McKenzie Engineering Corporation  
806 Broad Street  
Summersville, WV 26651

LEGEND	
Property line	—————
Edge of pavement or roadway	———
Corporation line	-----
District line	-----
County line	-----
Original lot line	----- (15)
Deed lot number	⊙ (15)
Parcel or index number	⊙ (99)
Improvement	○
Railroad	—+—+—+—

REVISIONS
1
2
3
4
5
6
7
8

RESTRICTION

All tax maps created under the provisions of reappraisal legislation are the property of Randolph County West Virginia and the reproduction, copying, distribution or sale of such tax maps or any copies thereof without the written permission of the Randolph County Assessor is prohibited by law.

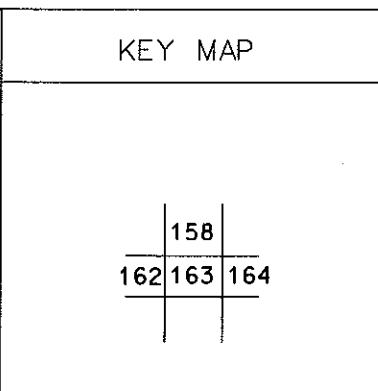

RANDOLPH COUNTY  
STATE OF WEST VIRGINIA  
Office of Assessor

DISTRICT HUTTONSVILLE  
SHEET NO: 163  
Date, Aerial Photography: April, 1963  
Photo No: 385-16-13  
Date, Map: June, 1963  
Scale: 1" = 400'