

101|102

102|

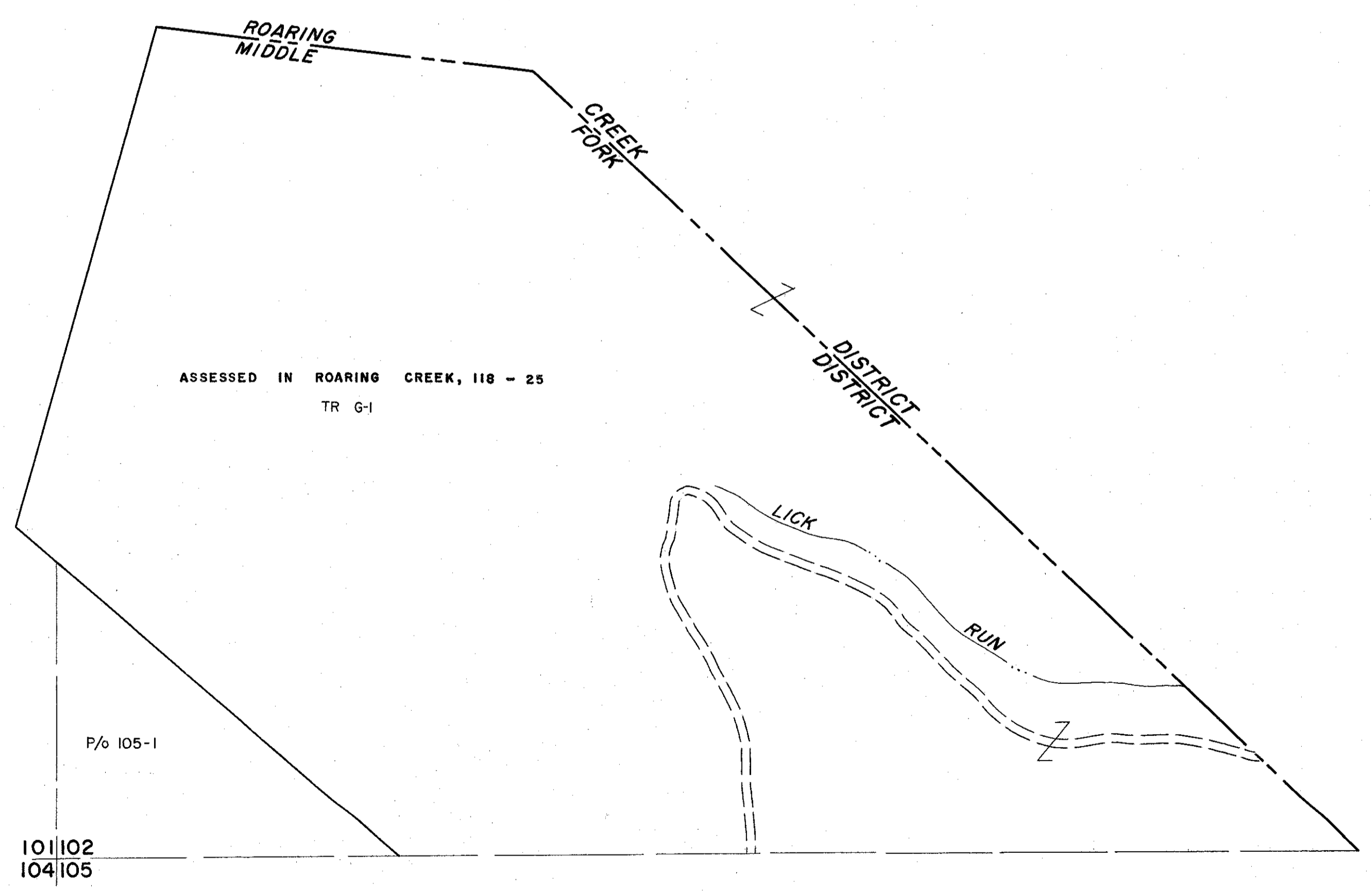

For Tax Purposes Only

Prepared by
MICHAEL BAKER, JR., INC.
Consulting Engineers
 Rochester, Pennsylvania

Legend

Property line	—	Original lot line	- - - - -
Edge of pavement or roadway	—	Deed lot number	(15)
Corporation line	- - - - -	Parcel or index number	(9)
District line	- - - - -	Improvement	o
County line	- - - - -	Railroad	—+—

Revisions

1	6-30-64	9	17
2	To 7.1.86 C.P.	10	18
3	OGIS 3/3/91	11	19
4		12	20
5		13	21
6		14	22
7		15	23
8		16	24

KEY MAP

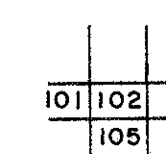

RANDOLPH COUNTY
 STATE OF WEST VIRGINIA
 Office of Assessor

DISTRICT

MIDDLE FORK

SHEET NO: 102

Date, Aerial Photography: April, 1963 Date, Maps, June, 1963
 Photo No: 385-8-6 Scale: 1" = 400'