

147 148
154 155

148 149
155 156

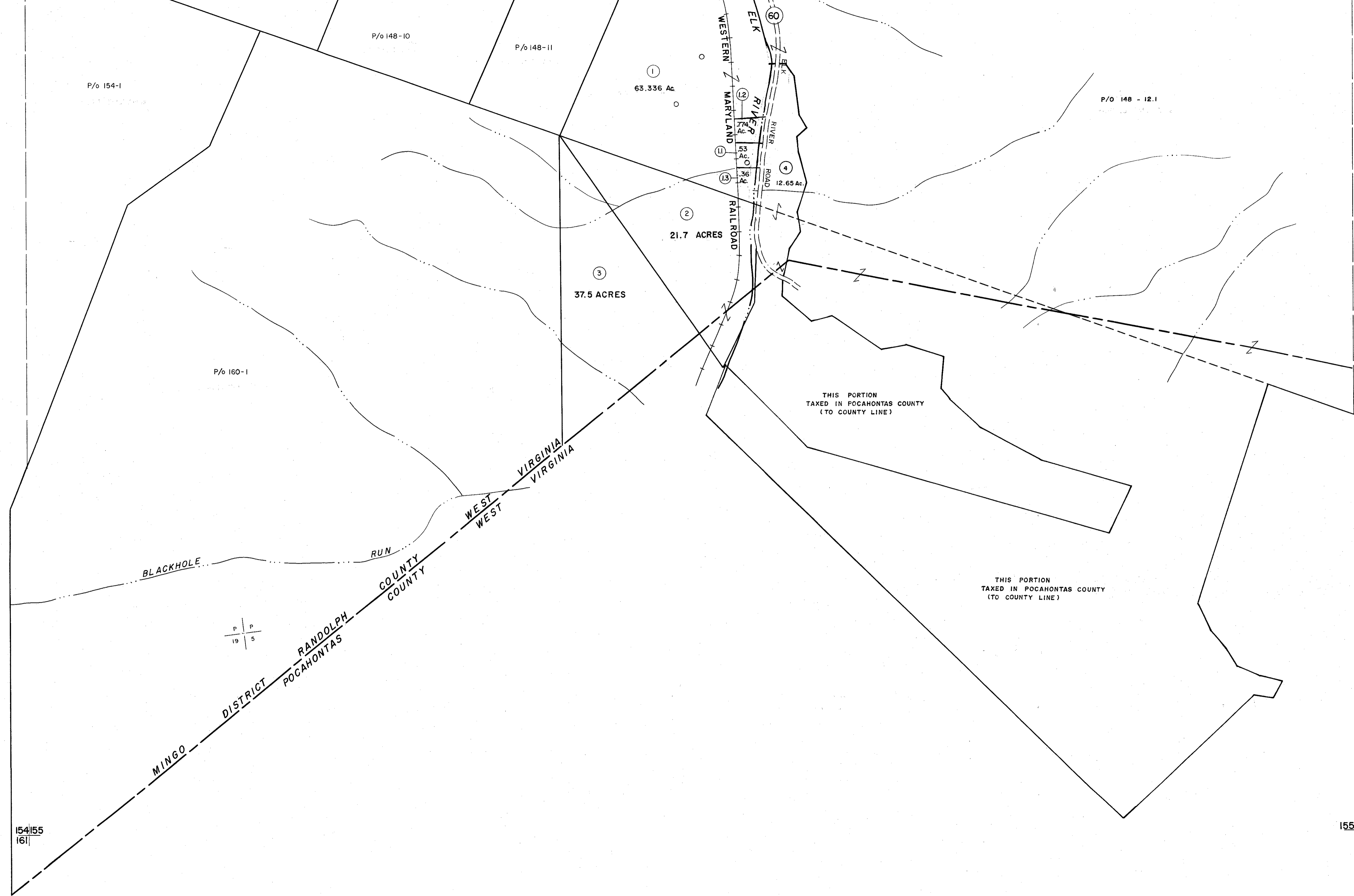

154 155
161

155 156

For Tax Purposes Only

Prepared by
MICHAEL BAKER, JR., INC.
Consulting Engineers
Rochester, Pennsylvania

Legend	
Property line	—
Edge of pavement or roadway	—
Corporation line	—
District line	—
County line	—
Original lot line	—
Deed lot number	(15)
Parcel or index number	(19)
Improvement	o
Railroad	—

Revisions			
1	6-30-64	2	O.G.I.S 5-1-96 J.E.B
2	July 1963	10	SLS INC.-J.W.M. 4/97
3	July 1966	11	
4	Revised to 7-1-89	12	
5	OGIS 2/24/91	13	
6	OGIS 4-15-92	14	
7	OGIS 3-94	15	
8	O.G.I.S 4-20-95	16	

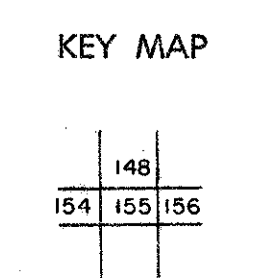

RANDOLPH COUNTY
STATE OF WEST VIRGINIA
Office of Assessor

DISTRICT
MINGO

SHEET NO: 155

Date, Aerial Photography: April, 1963 Date, Map: June, 1963
Photo No: 385-19-6 Scale: 1"=400'