

165  
167

165  
166  
167

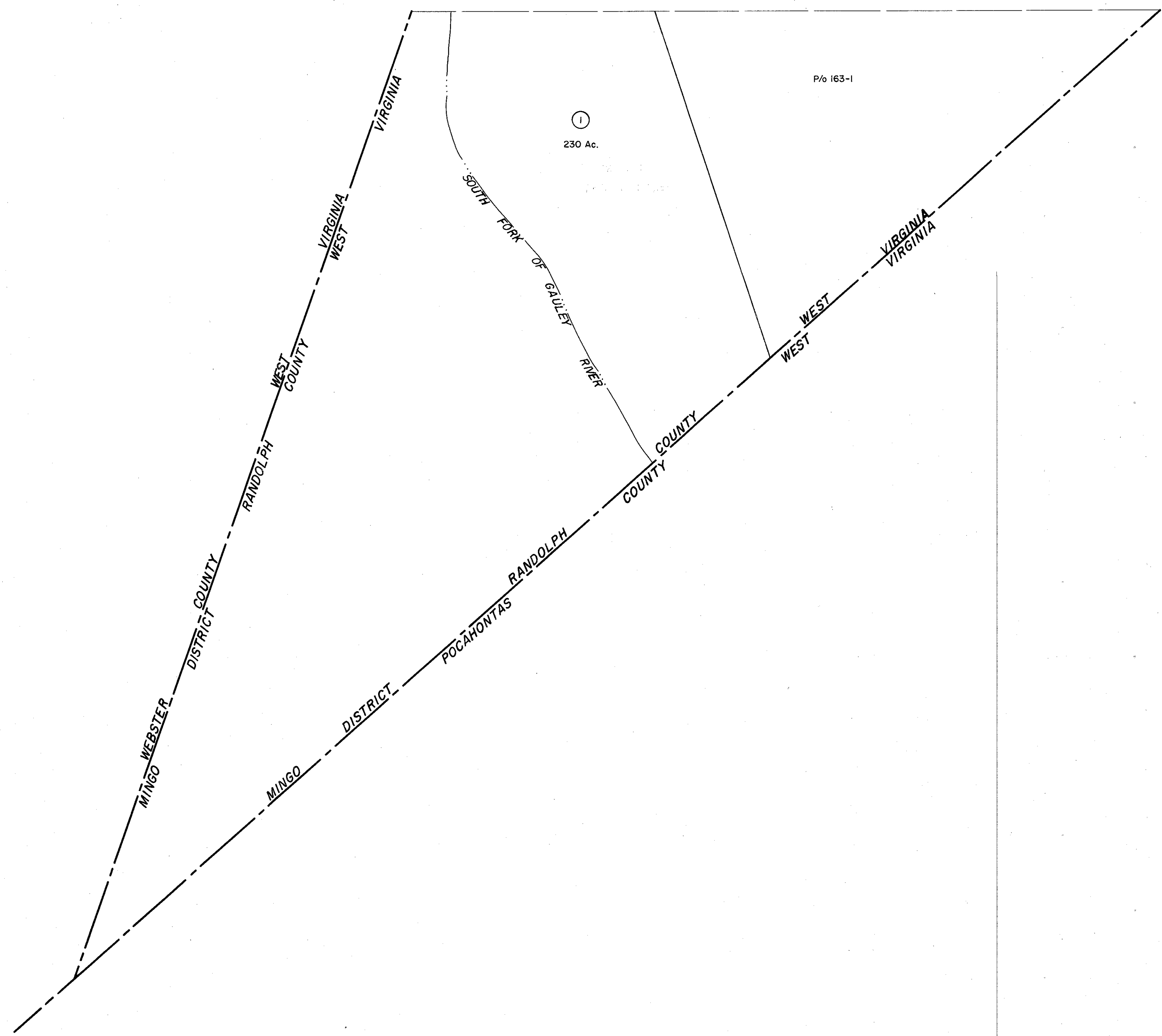

167

167

For Tax Purposes Only  
 Prepared by  
**MICHAEL BAKER, JR., INC.**  
 Consulting Engineers  
 Rochester, Pennsylvania

Legend	
Property line	———
Edge of pavement or roadway	———
Corporation line	———
District line	———
County line	———
Original lot line	———
Deed lot number	(15)
Parcel or index number	(2)
Improvement	o
Railroad	———

Revisions			
1	6-30-64	9	
2	Revised to 7-1-64 RCB	10	
3	OGIS 5/2/93 SAJ	11	
4		12	
5		13	
6		14	
7		15	
8		16	
		17	
		18	
		19	
		20	
		21	
		22	
		23	
		24	

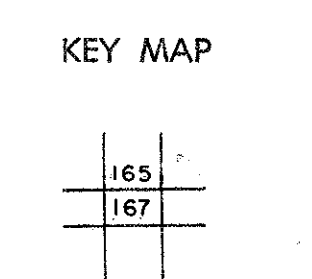

**RANDOLPH COUNTY**  
 STATE OF WEST VIRGINIA  
 Office of Assessor

DISTRICT	<b>MINGO</b>
SHEET NO:	<b>167</b>
Date, Aerial Photography:	April, 1963
Date, Map:	June, 1963
Photo No:	385-21-2
Scale:	1"=400'