

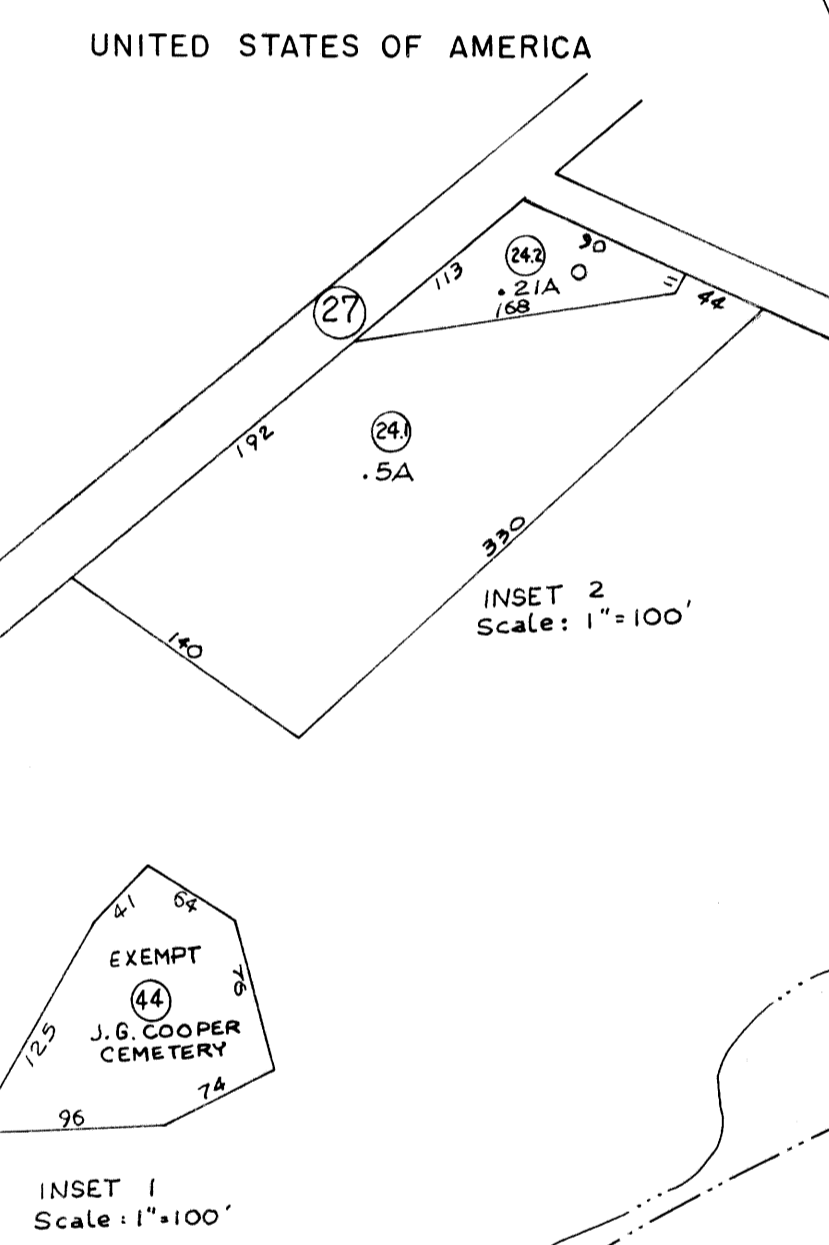

MATCH TO SHEET 23

MATCH TO SHEET 25



Legend

Property line	Original lot line
Edge of pavement or roadway	Deed lot number in parenthesis
Corporation line	Parcel or index number in circle
District line	Improvement
County line	Railroad

Revisions

1	Rodgers - Feb., 1962	9	REV. TO 7-1-88	R.E.B.	17
2	7-16-75	10	2-25-81		18
3	8-7-76	11	12/03/81		19
4	10/24/78	12	5/05/81		20
5	6/2/84	13			21
6		14			22
7	7/1/84	15			23
8	REV. TO 7-1-87	16			24

For Tax Purposes Only

Prepared by
AIR SURVEY CORPORATION
 1101 Lee Highway Arlington 9, Virginia

SUMMERS COUNTY - WEST VIRGINIA
 Office of Assessor

JUMPING BRANCH DISTRICT
 City - Town - District:
 Map No: **24**
 Date, Aerial Photography: APRIL 1959 Date, Map: 1960
 Photo No: 4(105) Scale: 1" = 400'