



FOR TAX PURPOSES ONLY
LANDMARK
 geospatial
 A Division of Landmark Forestry LLC

Legend	
	District Boundary
	Previous Deed
	Improvement
	Road Easement
	Railroad Right of Way
	Road Right of Way
	River

Restriction	
	Deed lot Number (15)
	Parcel or Index Number (9)
	Unknown
	Improvement
	Cemetery
	Church
	Educational

Revisions			
1	KIMBALL 1/1/2009	10	19
2	LANDMARK 8/1/2010	11	20
3	LANDMARK 9/7/2011	12	21
4	LANDMARK 4/24/2013	13	22
5	LANDMARK 7/29/2014	14	23
6		15	24
7		16	25
8		17	26
9		18	27
			28
			29
			30
			31
			32
			33
			34
			35
			36

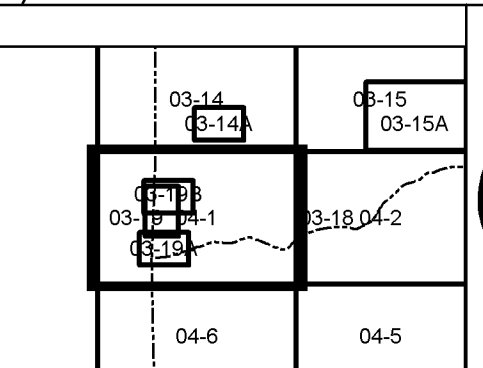

TAYLOR COUNTY
 Assessor's Office
 Christa Kinsey, Assessor
 GRAFTON, WV

FLEMINGTON
 District 04 Map No. 1
 Date of Publication: 1/27/2017
 Scale: 1"=400'