

406 407
427

407 408
427 428

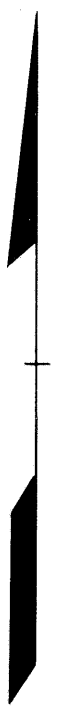
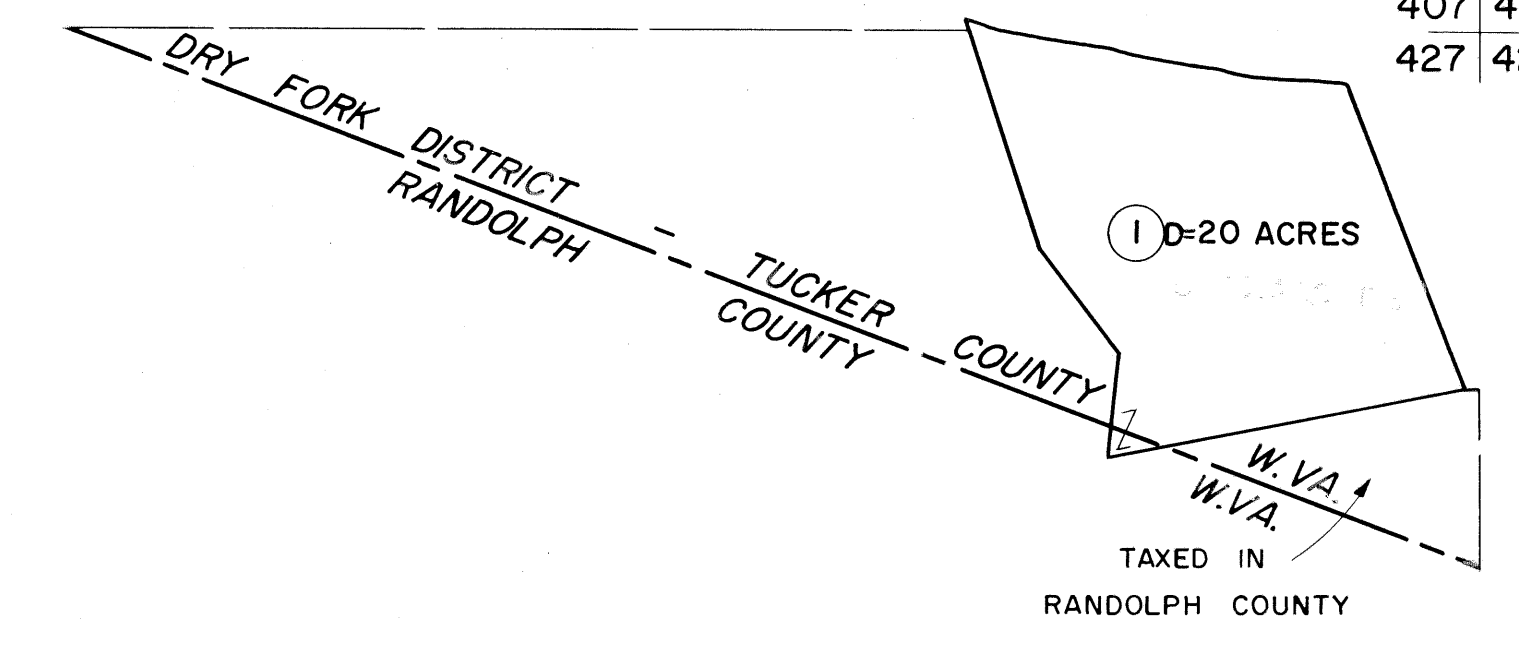

427

427 428

For Tax Purposes Only
Prepared by
MICHAEL BAKER, JR., INC.
Consulting Engineers
Rochester, Pennsylvania

Legend	
Property line	Original lot line
Edge of pavement or roadway	Deed lot number
Corporation line	Parcel or index number
District line	Improvement
County line	Railroad

Revisions			
1	REV. TO 7-1-83	NCS	9
2	OGIS 1/8/91	DSH	10
3	OGIS 12/12/93	SAJ	11
4			12
5			13
6			14
7			15
8			16

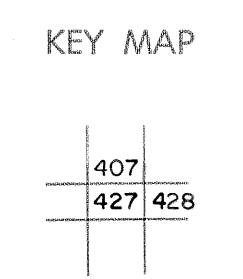

TUCKER COUNTY
STATE OF WEST VIRGINIA
Office of Assessor

DISTRICT
DRY FORK
SHEET NO: 427
Date, Aerial Photography: November, 1961 Date, Map: Dec., 1962
Photo No: Scale: 1" = 400'