

260
280

260 261
280 281

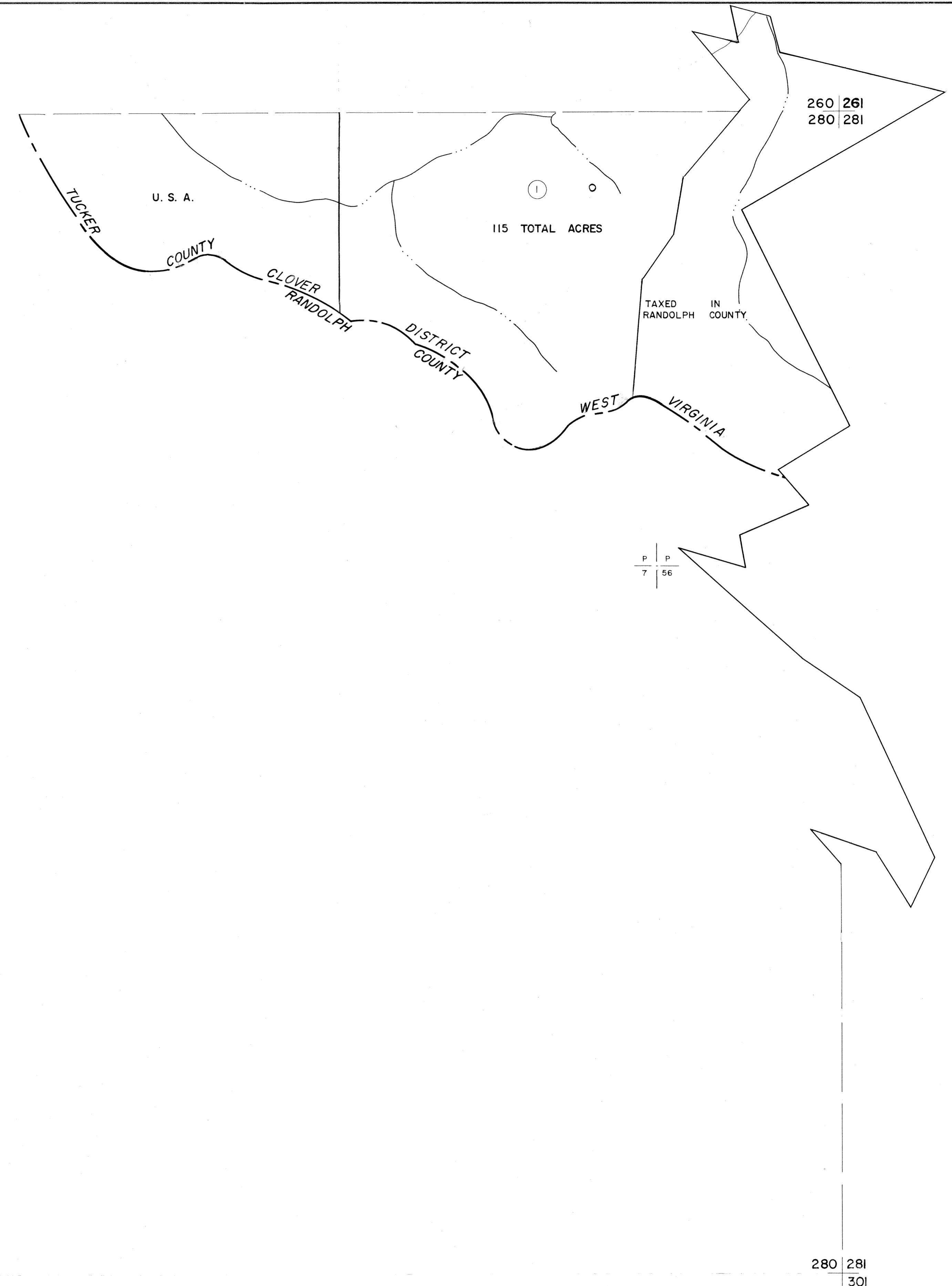

P | P
7 | 57

P | P
7 | 56

280

280 281
301

For Tax Purposes Only
 Prepared by
MICHAEL BAKER, JR., INC.
 Consulting Engineers
 Rochester, Pennsylvania

| Legend | |
|-----------------------------|-------|
| Property line | ----- |
| Edge of pavement or roadway | ----- |
| Corporation line | ----- |
| District line | ----- |
| County line | ----- |
| Original lot line | ----- |
| Dead lot number | (15) |
| Parcel or index number | (99) |
| Improvement | o |
| Railroad | ----- |

| Revisions | | | |
|-----------|-----------------|----|----|
| 1 | OGIS 3-19-92 TL | 9 | 17 |
| 2 | | 10 | 18 |
| 3 | | 11 | 19 |
| 4 | | 12 | 20 |
| 5 | | 13 | 21 |
| 6 | | 14 | 22 |
| 7 | | 15 | 23 |
| 8 | | 16 | 24 |

KEY MAP

TUCKER COUNTY
 STATE OF WEST VIRGINIA
 Office of Assessor

DISTRICT
CLOVER
 SHEET NO: 280
 Date, Aerial Photography: November, 1961 Date, Map: Dec., 1962
 Photo No: Scale: 1" = 400'