

406 407
427

407 408
427 428

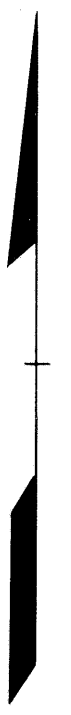
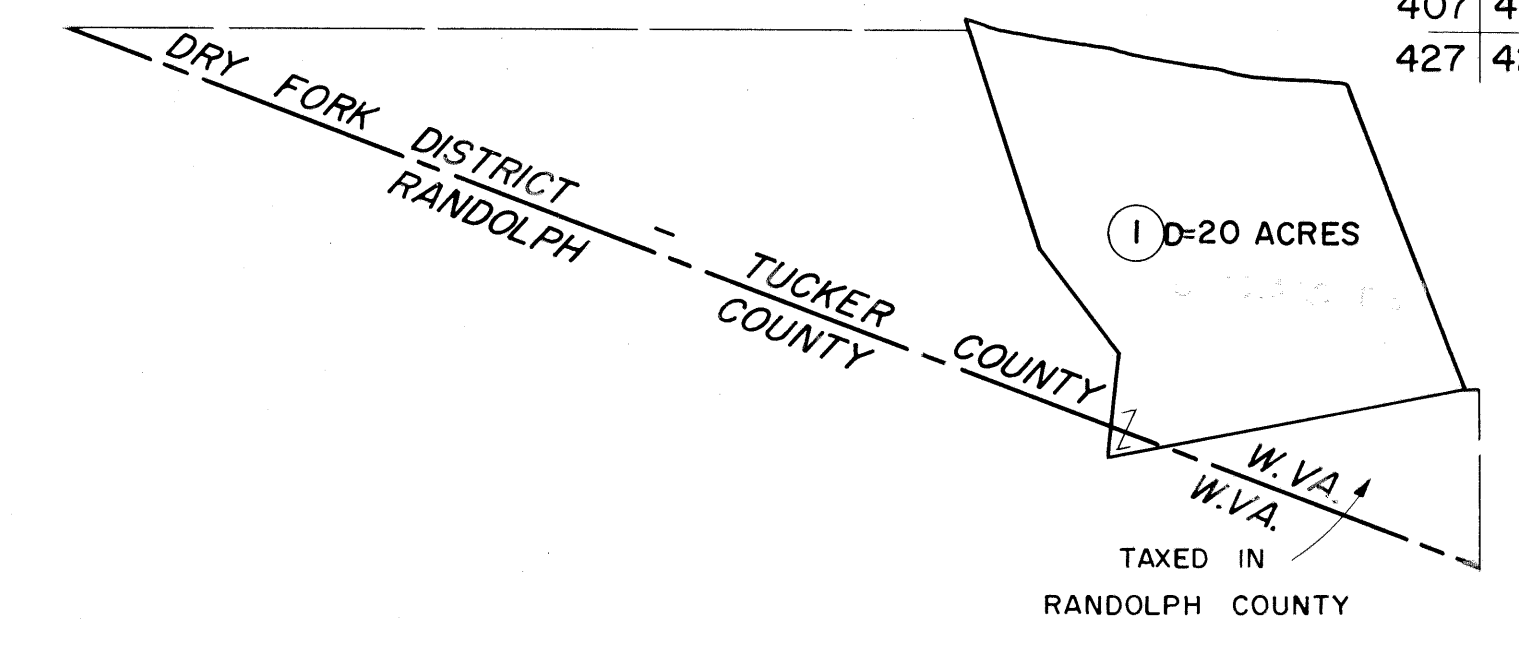

427

427 428

For Tax Purposes Only

Prepared by
MICHAEL BAKER, JR., INC.
Consulting Engineers
Rochester, Pennsylvania

Legend

| | | | |
|-----------------------------|-------|------------------------|-------|
| Property line | ----- | Original lot line | ----- |
| Edge of pavement or roadway | ----- | Deed lot number | (15) |
| Corporation line | ----- | Parcel or index number | (99) |
| District line | ----- | Improvement | o |
| County line | ----- | Railroad | + |

Revisions

| | | | | |
|---|----------------|-----|----|----|
| 1 | REV. TO 7-1-83 | NCS | 9 | 17 |
| 2 | OGIS 1/8/91 | DSH | 10 | 18 |
| 3 | OGIS 12/12/93 | SAJ | 11 | 19 |
| 4 | | | 12 | 20 |
| 5 | | | 13 | 21 |
| 6 | | | 14 | 22 |
| 7 | | | 15 | 23 |
| 8 | | | 16 | 24 |

KEY MAP

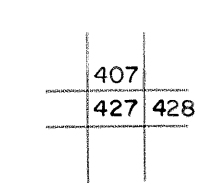

TUCKER COUNTY

STATE OF WEST VIRGINIA

Office of Assessor

DISTRICT

DRY FORK

SHEET NO: 427

Date, Aerial Photography: November, 1961 Date, Map: Dec., 1962
Photo No: Scale: 1" = 400'