

188 189
208 209

189 190
209 210

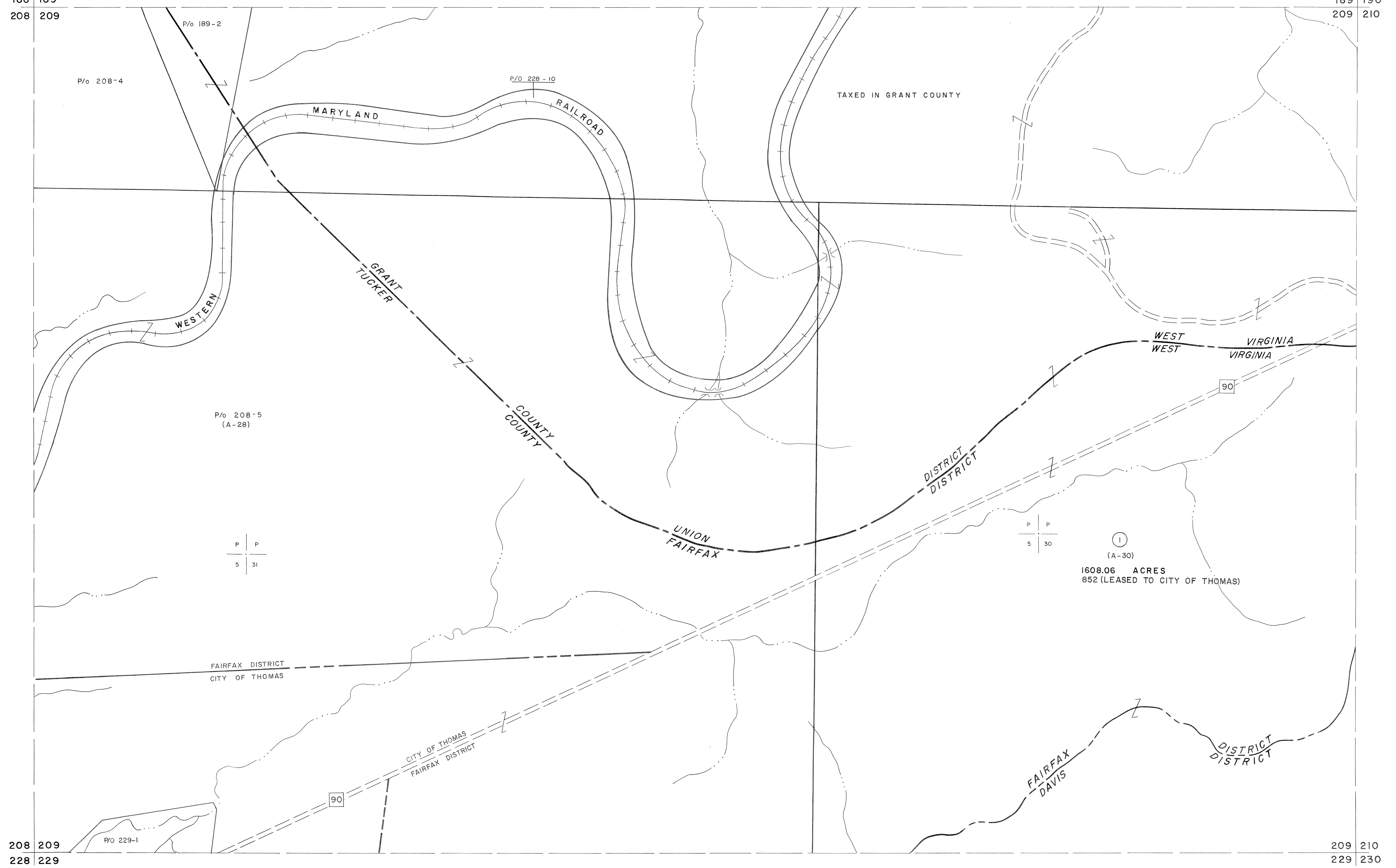

For Tax Purposes Only
 Prepared by
MICHAEL BAKER, JR., INC.
 Consulting Engineers
 Rochester, Pennsylvania

| Legend | |
|-----------------------------|------------------------|
| Property line | Original lot line |
| Edge of pavement or roadway | Deed lot number |
| Corporation line | Parcel or index number |
| District line | Improvement |
| County line | Railroad |

| Revisions | | | |
|-----------|-----------------|--------|----|
| 1 | REV. TO 7-1-86 | NCS | 17 |
| 2 | REV. TO 3-1-89 | R.E.B. | 18 |
| 3 | O.G.I.S. 4-1-96 | J.E.B. | 19 |
| 4 | 3/21/05 | S&H | 20 |
| 5 | | | 21 |
| 6 | | | 22 |
| 7 | | | 23 |
| 8 | | | 24 |

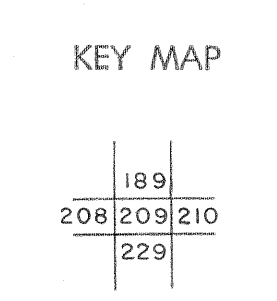

TUCKER COUNTY
 STATE OF WEST VIRGINIA
 Office of Assessor

| | |
|---------------------------|--------------|
| DISTRICT | DAVIS |
| SHEET NO: | 209 |
| Date, Aerial Photography: | Nov., 1961 |
| Photo No.: | |
| Date, Map: | Dec., 1962 |
| Scale: | 1" = 400' |