

MINGO CO. W.VA.
 WYOMING CO. W.VA.
 HUFF CREEK DIST.

123
127

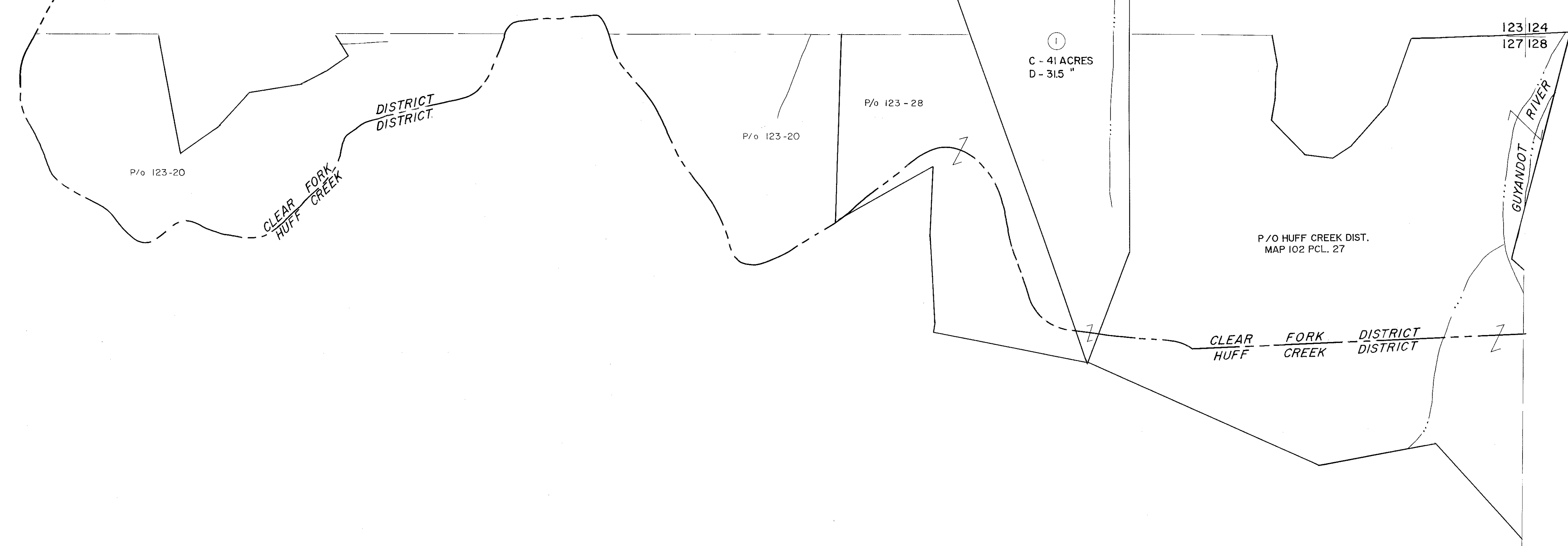

123 124
127 128

127

127 128

For Tax Purposes Only
 Prepared by
MICHAEL BAKER, JR., INC.
 Consulting Engineers
 Rochester, Pennsylvania

Legend	
Property line	—————
Edge of pavement or roadway	- - - - -
Corporation line	- · - · -
District line	- - - - -
County line	- - - - -
Original lot line	- - - - -
Deed lot number	(15)
Parcel or index number	(29)
Improvement	o
Railroad	—+—+—+—

Revisions			
1	3-1-64	9	17
2	Revised to 7-1-81	10	18
3	SLS INC. 11/11/98 DSW	11	19
4		12	20
5		13	21
6		14	22
7		15	23
8		16	24

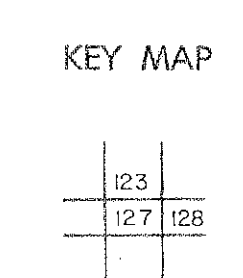

WYOMING COUNTY
 STATE OF WEST VIRGINIA
 Office of Assessor

DISTRICT **CLEAR FORK**
SHEET NO: 127
 Date, Aerial Photography: November, 1962 Date, Map: April, 1963
 Photo No. Scale: 1" = 400'