

103

103 104

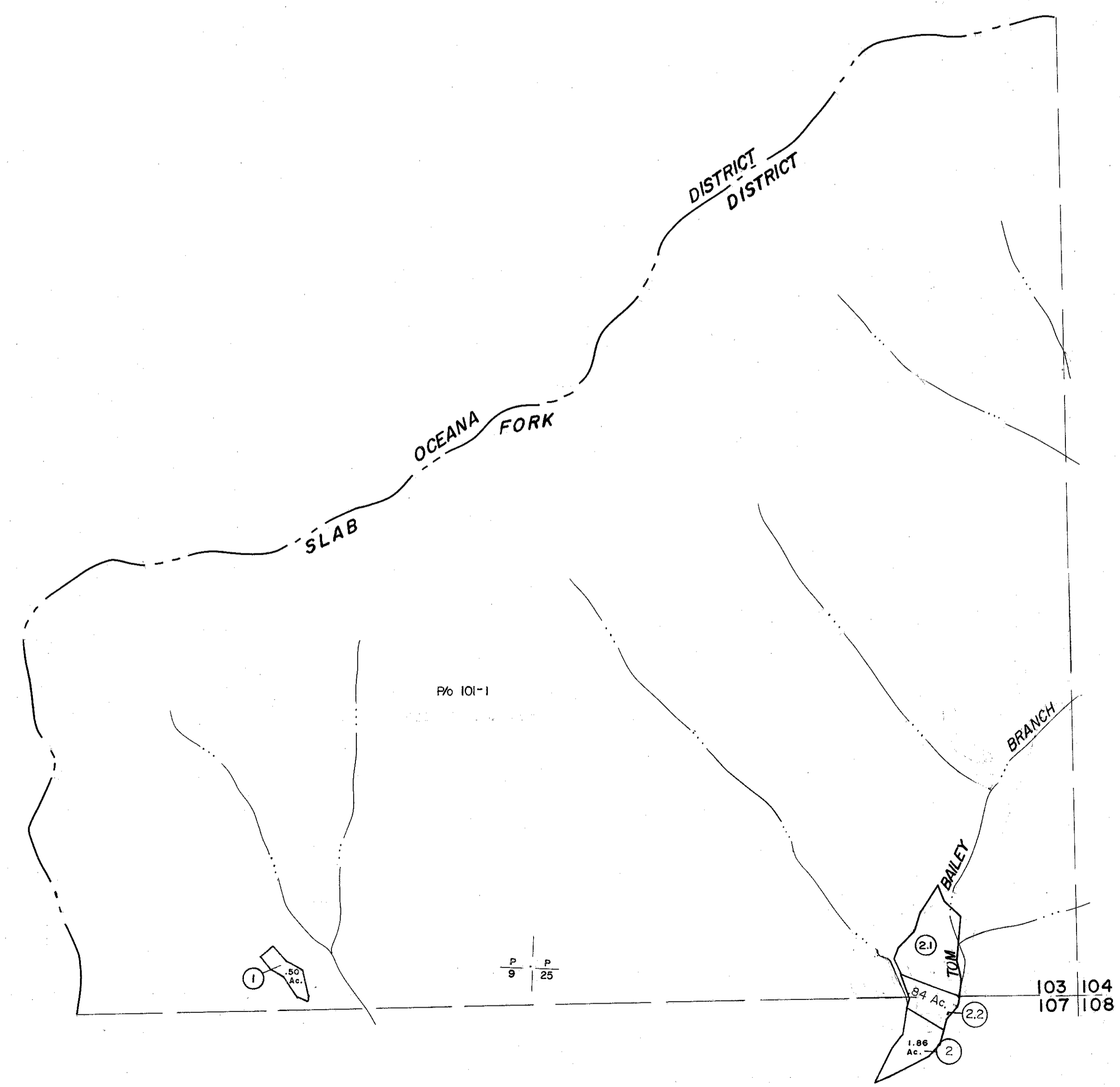

103  
107

103 104  
107 108

**For Tax Purposes Only**

Prepared by  
**MICHAEL BAKER, JR., INC.**  
Consulting Engineers  
Rochester, Pennsylvania

**Legend**

Property line	—————	Original lot line	-----
Edge of pavement or roadway	———	Deed lot number	(15)
Corporation line	-----	Parcel or index number	(99)
District line	-----	Improvement	o
County line	-----	Railroad	+

**Revisions**

1	3-1-64	9	17
2	MAR 75 PAM	10	18
3	REV TO 7-1-84 NCS	11	19
4	REV TO 7-1-84 NCS	12	20
5	REV TO 7-1-84 NCS	13	21
6	O.G.I.S 9-20-95 J.E.B	14	22
7	SLS INC. 1/8/98 DSW	15	23
8		16	24

**KEY MAP**

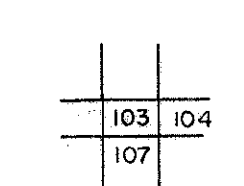

**WYOMING COUNTY**  
STATE OF WEST VIRGINIA  
Office of Assessor

DISTRICT  
**SLAB FORK**  
SHEET NO: 103

Date, Aerial Photography: November, 1962 Date, Map: April, 1963  
Photo No: Scale: 1" = 400'