

FOR TAX PURPOSES ONLY
Prepared By
Barbour County Assessor's Office
Philippi, West Virginia

This tax map was compiled for the purpose of taxation from available record evidence and has not been field verified. This map is not a valid survey plat and the data on the map does not imply any official status to such data. The State of West Virginia and the Barbour County Assessor's Office assume no liability that might result from the use of this map.

Legend
Property Line
Road Right of Way
Corporation Line
District Line
County Line
Original Lot Line
Lot Number
Parcel Number
Water
Railroad

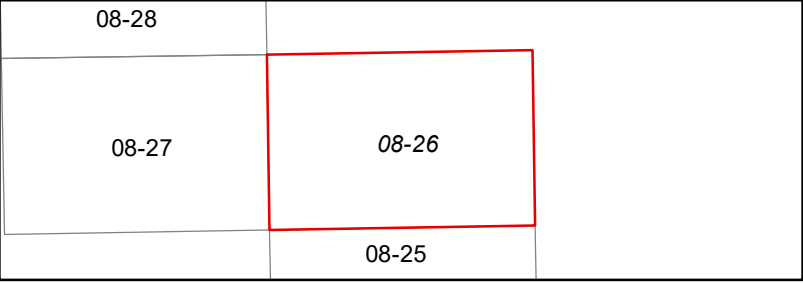

**BARBOUR COUNTY
WEST VIRGINIA**
Office of Assessor



PHILIPPI CORP
Map: 26
Date, Aerial Photography: 2010
Date, Map: 2/6/2024
Scale: 1" = 100'