

THIS DOCUMENT IS A TAX MAP: It was compiled for purposes of taxation from available record evidence and has not been field verified. This map is not a valid survey plat. The existence of data on this document does not imply any "official" status to such data. The W.V. State Tax Dept. and the Hancock County Assessor's Office assume no liability that might result from use of this document.

Legend			
Property Line	—	Original Lot Line	- - - - -
Road Right of Way	—	Lot Number	(15)
Corporation Line	—	Parcel Number	(99)
District Line	—	Water	- - - - -
County Line	—	Railroad	—+—+—+—
Road	- - - - -	Home/Commercial Building	●

R e v i s i o n s	1	Revised 07/20/2020	9		17	
	2	Revised 1/29/2021	10		18	
	3	Revised 1/25/2022	11		19	
	4	Revised 1/03/2023	12		20	
	5	Revised 1/18/2024	13		21	
	6		14		22	
	7		15		23	
	8		16		24	

STATE OF WEST VIRGINIA
HANCOCK COUNTY ASSESSOR
New Cumberland, West Virginia
Joseph M. Alongi, Assessor

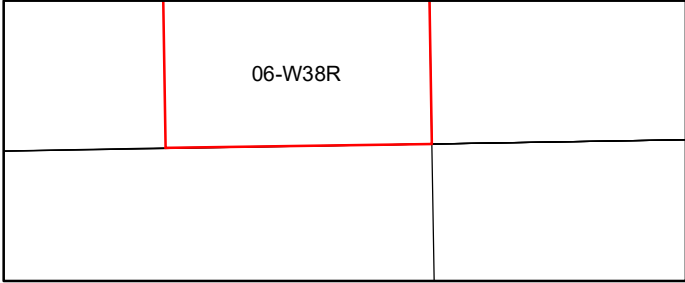

WEIRTON
Map: W38R

Date, Aerial Photography: 2003
Date, Map: 1/18/2024
Scale: 1" = 100'