

FOR TAX PURPOSES ONLY

Prepared By:

Glen D. "Houn' Dog" Adkins
Logan County, WV Tax Assessor

All finished tax maps created by provision of West Virginia law and are the property of the county assessors who created them. The reproduction, copying, distribution, sale or lease of such maps or copies thereof without the written permission of the respective county assessor is prohibited by law

Legend			
Property Line	—	Original Lot Line	- - - - -
Road Right of Way	—	Lot Number	(15)
Corporation Line	—	Parcel Number	(99)
District Line	—	Water	- - - - -
County Line	—	Railroad	—+—+—+—
Easement	- - - - -		

Coordinate System: NAD 1983 StatePlane West Virginia South FIPS 4702 Feet
Projection: Lambert Conformal Conic
Datum: North American 1983
False Easting: 1,968,500.0000
False Northing: 0.0000
Central Meridian: -81.0000
Standard Parallel 1: 37.4833
Standard Parallel 2: 38.8833
Latitude Of Origin: 37.0000
Units: Foot US

STATE OF WEST VIRGINIA
COUNTY OF LOGAN
Office of Assessor

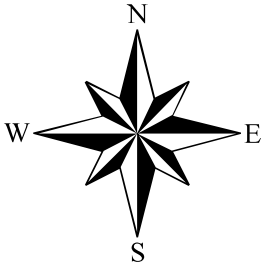
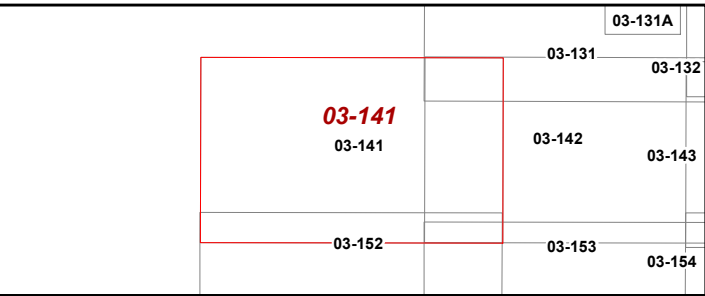

Island Creek Dist
Map: 141

Date, Aerial Photography: 2018

Date, Map: 12/7/2023

Scale: 1" = 400'

Date Last Revised: 5/4/2021