

FOR TAX PURPOSES ONLY

Prepared By:

Glen D. "Houn' Dog" Adkins  
Logan County, WV Tax Assessor

All finished tax maps created by provision of West Virginia law and are the property of the county assessors who created them. The reproduction, copying, distribution, sale or lease of such maps or copies thereof without the written permission of the respective county assessor is prohibited by law

Legend	
Property Line	Original Lot Line
Road Right of Way	Lot Number
Corporation Line	Parcel Number
District Line	Water
County Line	Railroad
Easement	

Coordinate System: NAD 1983 StatePlane West Virginia South FIPS 4702 Feet  
Projection: Lambert Conformal Conic  
Datum: North American 1983  
False Easting: 1,968,500.0000  
False Northing: 0.0000  
Central Meridian: -81.0000  
Standard Parallel 1: 37.4833  
Standard Parallel 2: 38.8833  
Latitude Of Origin: 37.0000  
Units: Foot US

STATE OF WEST VIRGINIA  
COUNTY OF LOGAN  
Office of Assessor

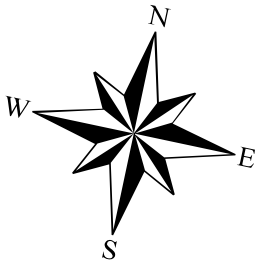
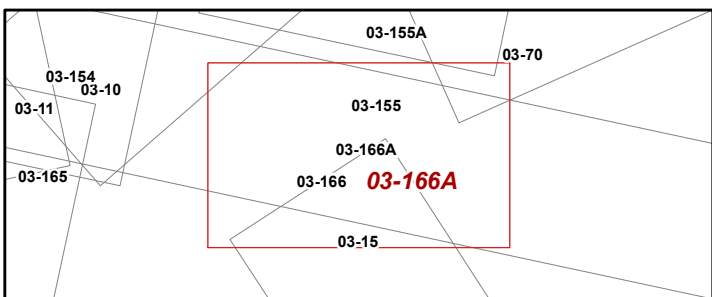

Island Creek Dist  
Map: 166A

Date, Aerial Photography: 2018  
Date, Map: 12/7/2023  
Scale: 1" = 100'  
Date Last Revised: 5/4/2021