

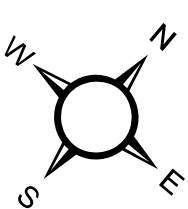

**WV LEGISLATIVE REGULATION**  
**TITLE 189 SERIES 2009**

**Disclaimer:**  
This tax map was compiled for purposes of taxation from available record evidence and has not been field verified. This map is not a valid survey plat and the data on this map does not imply any official status to such data. The State of West Virginia and county assessor's office assume no liability that might result from the use of this map.

**Restrictions:**  
All finished tax maps created under the provisions of legislation are the property of the county assessors who created them and the reproduction, copying, distribution, sale, or lease of such tax maps or copies thereof without the written permission of the respective county assessors is prohibited by law.



Legend					
Corporation line	---	Railroad	—+—+—+—	School	
District line	- - - - -	Lot line	---	Church	
County line	=====	Road Centerline	---	Deed lot number	(25)
State line	=====	Streams	---	Parcel or index number	923
Property Line	---	Trans Line	---	Parcel acreage	527.6
Right of Way	---	Cemetery	+		

Revisions					
1	AS OF JULY 1 1996	KWS	6	AS OF JULY 1 2001	JVB
2	AS OF JULY 1 1997	KWS	7	AS OF JULY 1 2002	JVB
3	AS OF JULY 1 1998	JVB	8	AS OF JULY 1 2003	JVB
4	AS OF JULY 1 1999	JVB	9	AS OF JULY 1 2004	JVB
5	AS OF JULY 1 2000	JVB	10	AS OF JULY 1 2005	JVB
11	AS OF JULY 1 2007	JVB	12	AS OF JULY 1 2008	RIR
13	AS OF JULY 1 2011	ASC	14	AS OF MAR 29 2012	ASC
15	AS OF JAN 1 2013	ASC	16	AS OF JAN 1 2014	ASC
17	AS OF JAN 1 2015	ASC	18	AS OF JAN 1 2020	AGD
19	AS OF JAN 1 2022	AGD	20	AS OF JAN 18 2024	AGD

**STATE OF WEST VIRGINIA**  
**COUNTY OF HAMPSHIRE**  
Office of Assessor

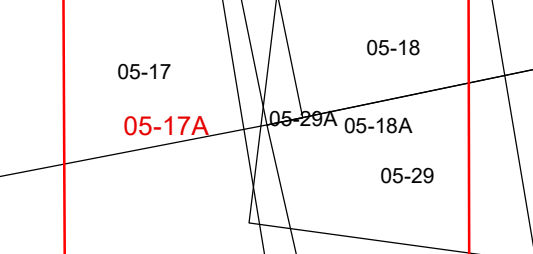

**Gore**  
**Map: 17A**  
**Created: 1/19/2024**  
**Scale: 1 in = 100 ft**